

# TRIOARC

The Leader in Climbing and Access Solutions



TO ORDER OR INQUIRE  
CONTACT  
DICK JONES SALES, INC.  
258 Baltimore St  
PO Box 141  
Hanover, PA 17331  
Phone 800-441-9955  
Fax 800-253-4036  
Email:  
[dickjones@dickjonessales.com](mailto:dickjones@dickjonessales.com)

Tri-Arc is the leading designer and manufacturer of platform fall protection systems in North America. Our EAS division has extensive experience and expertise in both commercial and military/DOD aviation. The EAS team is highly skilled at developing fixed wing and rotorcraft solutions for use in manufacturing, MRO and flight line environments. EAS provides complete turnkey solutions from design to installation and training of our high quality fall protection access solutions. Categories of aviation systems Tri-Arc designs and manufactures include **Docking Systems, Phase Maintenance Platforms, Engine Access Stands, Flight Line Stands, Adjustable-Height Maintenance Platforms, Wing Access Stands and Aircraft Custom Solutions.** Working from height in the aviation industry is an essential part of the manufacturing and MRO process. Tri-Arc's EAS division will customize a solution that successfully addresses OSHA compliance, safety, speed to completion and ergonomics.

## DOCKING SYSTEM PLATFORMS



Docking systems are tailored to each application based on the type of work being performed, and the aircraft being accessed.

### Features:

- Air and electric systems
- Multiple non-slip decking options
- Steel and aluminum construction
- Storage shelves and tool trays

## PHASE MAINTENANCE PLATFORMS

Phase maintenance platforms are designed and manufactured to the highest specifications to cover all areas of aircraft maintenance on fixed wing and rotorcraft aircraft.

### Features:

- Sliders and deck extensions conform to aircraft
- Adjustable height platforms
- Optional towing capabilities, shelving and lighting
- Removable and fold down handrails
- Anti-slip, anti-bounce safety tread
- Total lock swivel casters
- Kick panels
- Protective bumpers
- 50° safety angle ladders
- Quick assembly



## ENGINE ACCESS STANDS



Engine access stands are engineered to provide safe access to all types of aircraft engine configurations.

### Features:

- Ergonomic leaning platform
- Protective bumper
- Industrial grade leveling jacks
- Integrated control system
- Versatile removable guardrails
- Total ease of mobility

## FLIGHT LINE STANDS



EAS Flight line stands are designed to be mobile and versatile and can be configured to most fixed wing and rotorcraft aircraft.

### Features:

- Towable
- Lightweight construction
- All weather tread
- OSHA compliant
- Wheels for rough terrain
- High visibility features



## ADJUSTABLE-HEIGHT MAINTENANCE PLATFORMS



Adjustable height platforms provide the ability to operate at a wide range of platform heights. These platforms provide the user access to various working positions.



### Features:

- Manual or powered hydraulics
- Articulating ladder
- Optional fork truck pockets
- High capacity casters
- Redundant safety features
- OSHA compliant
- Locking slide out fingers
- Safety swing gates
- Optional tool holders

## WING ACCESS PLATFORMS



Wing access stands provide safe access to all types of aircraft wing applications.

### Features:

- Collapsible guardrails
- Inclined to match wing surface
- Modular construction
- Air and electric set up
- Multiple tow bars
- OSHA compliant

EAS specializes in designing, engineering and fabricating custom aviation access and fall protection products aimed at maximizing safety, productivity, ergonomics and OSHA compliance.

### Turnkey Design & Build Services:

- On-site application qualification and evaluations
- Solid modeling
- PE stamped drawings available
- Steel, aluminum or stainless steel construction
- Powder coat or galvanized finish
- Training and installation



# EAS INDUSTRIAL

ENGINEERED ACCESS SOLUTIONS

As a leader in the climbing and access industry for over 50 years, Tri-Arc has manufactured all types of access solutions designed to keep people safe and productive when working from height in industrial facilities. Tri-Arc offers the broadest range of product solutions for all industrial environments and applications. Below are some of the applications and products we have engineered and manufactured.

## VEHICLE MAINTENANCE ACCESS PLATFORMS



Bus Maintenance Platform



Military Truck Platform



Train Maintenance Platform



Reefer Truck Maintenance Platform

## MANUFACTURING ASSEMBLY ACCESS PLATFORMS



Articulating Dozer Access Platform



Injection Molding Access Platform



Combine Assembly Platform



Modular Wrap-Around Work Platforms

## CANTILEVER PLATFORMS



Mobile Lean Over Platform



Gondola Access Platform



Conveyer Supported Cantilever Inspection Platform



Supported Lean-Over Cantilever Ladder

## WORK CELL/PRODUCTION PLATFORMS



Composite Layout Access Platform



Turbine Engine Docking System



Vertical Engine Stand



Adjustable Turbine Engine Stand

## ADJUSTABLE HEIGHT PLATFORMS



Mobile Articulating Access Ladder



Optics Installation Platform



Adjustable Height Dozer Platform



Height Adjustable Wrap-Around Work Platform

## TRAILER ACCESS PLATFORMS

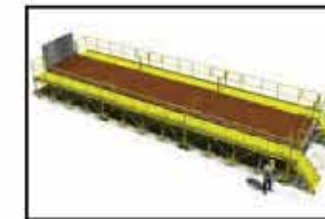

Flatbed Trailer Access Platform



Box Trailer Mobile Stand



Mobile Trailer Rooftop Platform



Mobile Tarping Guardrail Platform

## CROSSOVER STAIRS



Turbine Assembly Crossover



L-Shaped Conveyor Crossover



Rooftop Conduit Crossover



U-Shaped Exterior Wall Crossover

## FIXED CAGE LADDER SYSTEMS



Silo Fixed Cage Ladders



Ladders with Retracted Bottoms



Caged Ladder with Exit Platforms

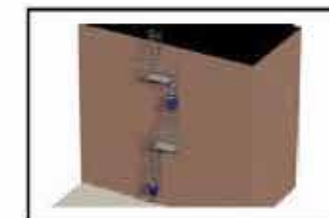

Roof Ladders with Rest Platforms

## POWER GENERATION ACCESS PLATFORMS



Gearbox Access Platforms



Nacelle Access Platform



Windmill Blade Access Platform



Well Head Access Platforms

## INDUSTRIAL STAIRS



Submarine Maintenance Platform

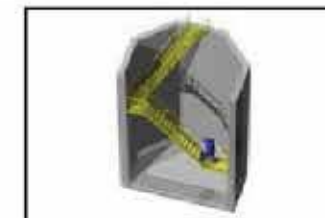

Atomizer Pit Access Stairs

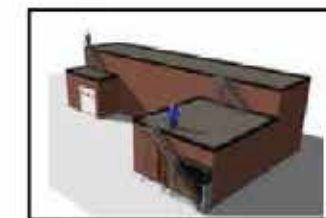

Access Stairs for Multi-Level Roof

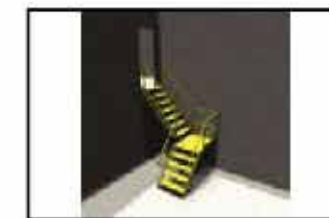

Steel Industrial Stairs

# U-DESIGN

CONFIGURABLE PRODUCTS



**CREATE THE PERFECT SOLUTION FOR YOUR NEEDS**

U-Design Configurable Products was developed as a unique and innovative way to more effectively and efficiently identify, select and then purchase the most suitable ladder model for your climbing and access needs, while receiving a custom solution at an off-the-shelf price. Proper ladder selection is one of the most important factors in helping ensure workplace safety. ANSI, OSHA and the American Ladder Institute discuss the importance of ladder selection within their standards and outreach information. U-Design Configurable Products provides a simple step-by-step selection process to easily determine the right ladder to safely work from. U-Design Configurable Products by Tri-Arc include: Crossover Platforms, Cantilever Ladders, Rolling Ladders, Rooftop Platforms and Max-Access Platform System.

## U-DESIGN CONFIGURABLE PRODUCTS



## U-DESIGN CROSSOVER PLATFORMS

A crossover platform allows a person to safely walk over an obstacle or hazardous area instead of having to go around or through it. Crossovers can increase productivity as well as safety by improving access to hard-to-reach areas. You can select the parts needed to create your own specially configured U-Design crossover by following the steps below.

### Features:

- Steel construction
- 1"x2" Reinforced rectangular tube
- Yellow powder coat finish
- 1000 Lb. capacity
- Clearance height is 2" below platform height
- Perforated or Grip Strut tread
- 42" Guardrail height
- Combine 20" or 30" Bridge spans to create desired horizontal clearance
- Leg kit required for spans greater than 90" in length
- Rail Kit item URK used in place of ladder to close off platform opening



1. Select an incline



2. Select a stair height

3. Select a bridge span

4. Select a configuration

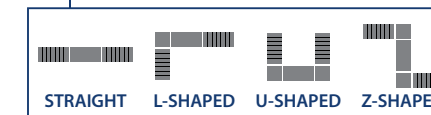

STANDARD ANGLE BASE LADDER								
PERFORATED	SERRATED							
Tri-Arc Model #	Tri-Arc Model #	# of Steps	Step Width	Step Depth	Platform Height	Overall Height	Base Width	Vertical Clearance
<b>50° Incline</b>								
UCL5003246	UCL5003242	3	24"	10"	30"	72"	26.5"	28"
UCL5004246	UCL5004242	4	24"	10"	40"	82"	26.5"	38"
UCL5005246	UCL5005242	5	24"	10"	50"	92"	26.5"	48"
UCL5006246	UCL5006242	6	24"	10"	60"	102"	26.5"	58"
UCL5007246	UCL5007242	7	24"	10"	70"	112"	26.5"	68"
UCL5008246	UCL5008242	8	24"	10"	80"	122"	26.5"	78"
UCL5009246	UCL5009242	9	24"	10"	90"	132"	26.5"	88"
<b>75° Incline</b>								
UCL7503246	UCL7503242	3	24"	7"	30"	72"	26.5"	28"
UCL7504246	UCL7504242	4	24"	7"	40"	82"	26.5"	38"
UCL7505246	UCL7505242	5	24"	7"	50"	92"	26.5"	48"
UCL7506246	UCL7506242	6	24"	7"	60"	102"	26.5"	58"
UCL7507246	UCL7507242	7	24"	7"	70"	112"	26.5"	68"
UCL7508246	UCL7508242	8	24"	7"	80"	122"	26.5"	78"
UCL7509246	UCL7509242	9	24"	7"	90"	132"	26.5"	88"
<b>90° Incline</b>								
UCL9003246		3	24"	2.5"	30"	72"	30"	28"
UCL9004246		4	24"	2.5"	40"	82"	30"	38"
UCL9005246		5	24"	2.5"	50"	92"	30"	48"
UCL9006246		6	24"	2.5"	60"	102"	30"	58"
UCL9007246		7	24"	2.5"	70"	112"	30"	68"
UCL9008246		8	24"	2.5"	80"	122"	30"	78"
UCL9009246		9	24"	2.5"	90"	132"	30"	88"

BRIDGE SPAN				
PERFORATED	SERRATED			
Tri-Arc Model #	Tri-Arc Model #	Span Length	Span Width	Base Width
UCB20246	UCB20242	20"	24"	30"
UCB30246	UCB30242	30"	24"	30"

Combine 20" & 30" spans up to a total of 90" uninhibited span clearance length.

LEG KIT	
Tri-Arc Model #	For Step Sizes
ULK0324	3
ULK0424	4
ULK0524	5
ULK0624	6
ULK0724	7
ULK0824	8
ULK0924	9

Use a Leg Kit when overall bridge length must be greater than 90". Pick based on number of steps and place between Bridge Spans so that no span exceeds 90" between Ladders, Turn Platforms, or Leg Kits.

TURN PLATFORM								
PERFORATED	SERRATED							
Tri-Arc Model #	Tri-Arc Model #	For Step Sizes	Platform Width	Base Width	Platform Height	Overall Height	Platform Length	Vertical Clearance
UCT03246	UCT03242	3	24"	31"	30"	72"	30.5"	28"
UCT04246	UCT04242	4	24"	31"	40"	82"	30.5"	38"
UCT05246	UCT05242	5	24"	31"	50"	92"	30.5"	48"
UCT06246	UCT06242	6	24"	31"	60"	102"	30.5"	58"
UCT07246	UCT07242	7	24"	31"	70"	112"	30.5"	68"
UCT08246	UCT08242	8	24"	31"	80"	122"	30.5"	78"
UCT09246	UCT09242	9	24"	31"	90"	132"	30.5"	88"

## U-DESIGN CANTILEVER LADDERS

A cantilever ladder provides access above an obstacle or hard to reach area by allowing the platform to cantilever beyond the back of the ladder. Choose from either the Unsupported model which is counterweighted for capacity or the Supported model that has a bottom support legs that can roll under the obstacle. The Cantilever Conversion Kit allows an Unsupported model to be converted to a Supported model by removing the counterweight and adding the bottom extension.

### Features:

- 300 lb. rated capacity
- 1"x2" rectangular tube construction
- 24" wide steps and platform
- 50° safety angle incline ladder
- 5"x2" locking casters
- Powder coat yellow finish
- Meets OSHA 1910.29 & ANSI A14.7
- Clearance height is 2" less than platform height

### Supported Cantilever

Same features as the Unsupported Cantilever

Support leg rolls under obstructions like tanks, trucks, or machines

Allows cantilevered access without added counterweight



Platform heights from 50" (5-step) to 90" (9-step)

Cantilevered platform is available up to 40" long

Counterweighted for a 300 lb. capacity

### Unsupported Cantilever

# of Steps	SUPPORTED CANTILEVER		UNSUPPORTED CANTILEVER		Platform Height	Clear Height (to floor)*	Overall Height	Platform W x L	SUPPORTED		UNSUPPORTED	
	PERFORATED Tri-Arc Model #	SERRATED Tri-Arc Model #	PERFORATED Tri-Arc Model #	SERRATED Tri-Arc Model #					Base W x D	Base W x D		
<b>20" Cantilever Length</b>												
5	UCS500520246	UCS500520242	UCU500520246	UCU500520242	50"	48"	92"	24 x 20	41" x 64"	30" x 64"		
6	UCS500620246	UCS500620242	UCU500620246	UCU500620242	60"	58"	102"	24 x 20	41" x 72"	30" x 72"		
7	UCS500720246	UCS500720242	UCU500720246	UCU500720242	70"	68"	112"	24 x 20	41" x 81"	30" x 81"		
8	UCS500820246	UCS500820242	UCU500820246	UCU500820242	80"	78"	122"	24 x 20	41" x 89"	30" x 89"		
9	UCS500920246	UCS500920242	UCU500920246	UCU500920242	90"	88"	132"	24 x 20	41" x 97"	30" x 97"		
<b>30" Cantilever Length</b>												
5	UCS500530246	UCS500530242	UCU500530246	UCU500530242	50"	48"	92"	24 x 30	41" x 74"	30" x 74"		
6	UCS500630246	UCS500630242	UCU500630246	UCU500630242	60"	58"	102"	24 x 30	41" x 82"	30" x 82"		
7	UCS500730246	UCS500730242	UCU500730246	UCU500730242	70"	68"	112"	24 x 30	41" x 91"	30" x 91"		
8	UCS500830246	UCS500830242	UCU500830246	UCU500830242	80"	78"	122"	24 x 30	41" x 99"	30" x 99"		
9	UCS500930246	UCS500930242	UCU500930246	UCU500930242	90"	88"	132"	24 x 30	41" x 107"	30" x 107"		
<b>40" Cantilever Length</b>												
5	UCS500540246	UCS500540242	UCU500540246	UCU500540242	50"	48"	92"	24 x 40	41" x 84"	30" x 84"		
6	UCS500640246	UCS500640242	UCU500640246	UCU500640242	60"	58"	102"	24 x 40	41" x 92"	30" x 92"		
7	UCS500740246	UCS500740242	UCU500740246	UCU500740242	70"	68"	112"	24 x 40	41" x 101"	30" x 101"		
8	UCS500840246	UCS500840242	UCU500840246	UCU500840242	80"	78"	122"	24 x 40	41" x 109"	30" x 109"		
9	UCS500940246	UCS500940242	UCU500940246	UCU500940242	90"	88"	132"	24 x 40	41" x 117"	30" x 117"		

### SUPPORTED CANTILEVER CONVERSION KIT

Converts a counterweighted Unsupported Cantilever to a Supported Cantilever by adding the base support kit to the base of the ladder and removing and storing the counterweight.

Tri-Arc Model #	Description
UCB2024	20" Extension bottom kit for 20" Cantilever models
UCB3024	30" Extension bottom kit for 30" Cantilever models
UCB4024	40" Extension bottom kit for 30" Cantilever models

## U-DESIGN ROLLING LADDERS & SAFETY ANGLE ROLLING LADDERS

Configure a steel rolling ladder exactly how you want it by choosing from the feature kits including the deep top kit, the all-directional kit, and the stock picking kit. Combine features to build the most productive ladder for your needs.

### Features:

- 450 lb. load rating
- 24" wide steps
- 7" deep treads (56° models)
- 10" deep platform (56° models)
- 17" deep platform (50° models)
- 8.5" deep treads (56° models)
- Step-Lock standard on all models
- Meets OSHA & ANSI standards
- Gray powder-coated finish
- Ships unassembled

Start with a basic ladder



### Customize by adding a feature kit

Add a Deep Top Kit



Add an All-Directional Kit



Add a Stock Picking Kit



STANDARD ANGLE BASE LADDER							
PERFORATED Tri-Arc Model #	SERRATED Tri-Arc Model #	# of Steps	Platform Height	Overall Height	Step Width	Platform W x L	Base W x L
UKDSR106246	UKDSR106242	6	60"	96"	24"	24" x 10"	35" x 50"
UKDSR107246	UKDSR107242	7	70"	106"	24"	24" x 10"	35" x 57"
UKDSR108246	UKDSR108242	8	80"	116"	24"	24" x 10"	35" x 64"
UKDSR109246	UKDSR109242	9	90"	126"	24"	24" x 10"	35" x 69"
UKDSR110246	UKDSR110242	10	100"	136"	24"	24" x 10"	35" x 76"
UKDSR111246	UKDSR111242	11	110"	146"	24"	24" x 10"	35" x 83"
UKDSR112246	UKDSR112242	12	120"	156"	24"	24" x 10"	35" x 90"
UKDSR113246	UKDSR113242	13	130"	166"	24"	24" x 10"	40" x 96"
UKDSR114246	UKDSR114242	14	140"	176"	24"	24" x 10"	40" x 103"
UKDSR115246	UKDSR115242	15	150"	186"	24"	24" x 10"	40" x 110"

SAFETY ANGLE BASE LADDER							
PERFORATED Tri-Arc Model #	SERRATED Tri-Arc Model #	# of Steps	Platform Height	Overall Height	Step Width	Platform W x L	Base W x L
UKDEC106246	UKDEC106242	6	60"	96"	24"	24" x 17"	35" x 66"
UKDEC107246	UKDEC107242	7	70"	106"	24"	24" x 17"	35" x 74"
UKDEC108246	UKDEC108242	8	80"	116"	24"	24" x 17"	35" x 82"
UKDEC109246	UKDEC109242	9	90"	126"	24"	24" x 17"	35" x 91"
UKDEC110246	UKDEC110242	10	100"	136"	24"	24" x 17"	35" x 99"
UKDEC111246	UKDEC111242	11	110"	146"	24"	24" x 17"	35" x 107"
UKDEC112246	UKDEC112242	12	120"	156"	24"	24" x 17"	35" x 116"
UKDEC113246	UKDEC113242	13	130"	166"	24"	24" x 17"	40" x 124"
UKDEC114246	UKDEC114242	14	140"	176"	24"	24" x 17"	40" x 133"
UKDEC115246	UKDEC115242	15	150"	186"	24"	24" x 17"	40" x 141"

DEEP TOP PLATFORM KIT		
PERFORATED Tri-Arc Model #	SERRATED Tri-Arc Model #	DESCRIPTION
UP20DTK	UG20DTK	Adds 10" additional length to top platform (20" or 27" total)
UP30DTK	UG30DTK	Adds 20" additional length to top platform (30" or 37" total)

ALL-DIRECTIONAL MANEUVERABILITY KIT		
Tri-Arc Model #	Kit Matching	Description
U4AD0612	6 thru 12 step models	Enables the ladder to turn within its own radius
U4AD1315	13 thru 15 step models	

STOCK PICKING SHELVES KIT		
Tri-Arc Model #	Kit Matching	Description
USPK2	6 thru 7 step models	Two 50 lb. capacity shelves
USPK3	8 thru 15 step models	Three 50 lb. capacity shelves

## U-DESIGN ROOFTOP PLATFORMS

A rooftop platform allows you to easily create safe access over pipes and other rooftop obstacles. Special support feet distribute weight to prevent damage to roof membranes. You can select the parts needed to create your own specially configured U-Design rooftop platform by following the steps below.

### Features:

- Aluminum, 1" x 2" rectangular tube construction
- Clearance height is 2.5" less than platform height
- 500 lb. rated capacity
- 36" wide steps and bridge spans
- Serrated tread surface
- Non-Penetrating Caddy feet - distributes weight evenly to protect roof surface
- 42" guardrail height
- 40" long bridge span that can be combined to create up to 120" uninhibited clearance length



#### 1. Select an incline



#### 2. Select a stair height

#### 3. Select a bridge span

#### 4. Select a configuration

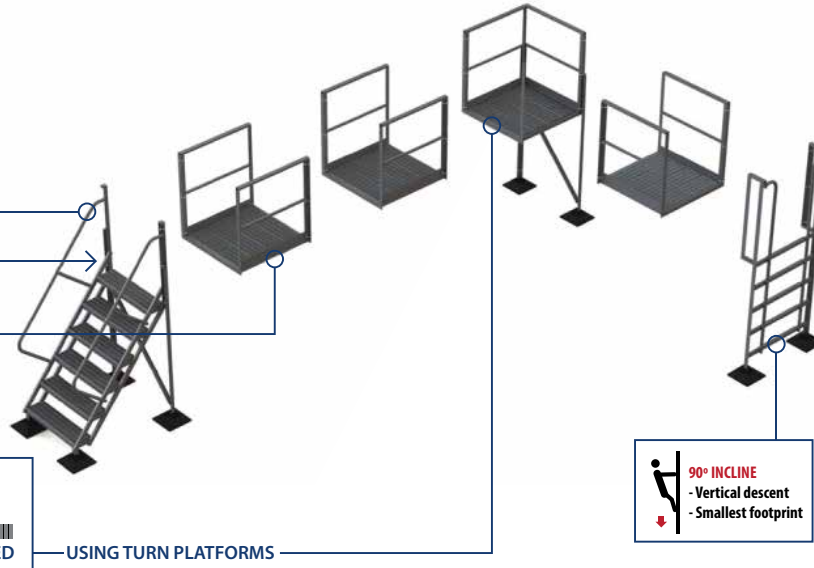
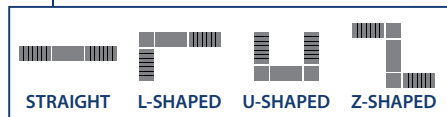

LADDER							
Tri-Arc Model #	# of Steps	Top Step Height	Vertical Clearance	Step Width	Step Depth	Overall Height	Overall Width
<b>50° Incline</b>							
URTL502	2	20"	17.5"	36"	9.5"	62"	46.25"
URTL503	3	30"	27.5"	36"	9.5"	72"	52.75"
URTL504	4	40"	37.5"	36"	9.5"	82"	52.75"
URTL505	5	50"	47.5"	36"	9.5"	92"	52.75"
URTL506	6	60"	57.5"	36"	9.5"	102"	52.75"
<b>90° Incline</b>							
URTL902	-	20"	17.5"	24"	1.625"	62"	52.25"
URTL903	-	30"	27.5"	24"	1.625"	72"	52.25"
URTL904	-	40"	37.5"	24"	1.625"	82"	52.25"
URTL905	-	50"	47.5"	24"	1.625"	92"	52.25"
URTL906	-	60"	57.5"	24"	1.625"	102"	52.25"

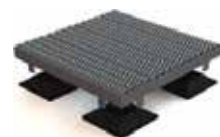

URTO3636

ADJUSTABLE-HEIGHT WALKING PLATFORM	
Tri-Arc Model #	36" x 36" serrated platform with adjustable height from 11" to 14". Platform is 3" thick aluminum construction, with a capacity of 500 lbs.
URTO3636	Platforms may be combined together to create a larger walking surface, but CANNOT be joined to the crossover components above.

BRIDGE SPAN							
Tri-Arc Model #	Span Length	Walkway Width	Overall Width	Combine up to a total of 120" uninhibited span clearance length. Longer spans require Support Legs.			
URTSB36	40"	38"	42"				
TURN PLATFORM							
Tri-Arc Model #	For Step Sizes	Platform Height	Vertical Clearance	Platform Width	Overall Height	Overall Width	Platform Length
URTP20	2	20"	17.5"	36"	62"	52.75"	40"
URTP30	3	30"	27.5"	36"	72"	52.75"	40"
URTP40	4	40"	37.5"	36"	82"	52.75"	40"
URTP50	5	50"	47.5"	36"	92"	52.75"	40"
URTP60	6	60"	57.5"	36"	102"	52.75"	40"

GUARDRAIL ENCLOSURE	
Tri-Arc Model #	Kit includes guardrail, mid-rail, toeboard and hardware to close any walkway opening. Must be paired with a Leg Kit.
URTRK1	

LEG KIT	
Tri-Arc Model #	For Step Sizes
URTSL20	2
URTSL30	3
URTSL40	4
URTSL50	5
URTSL60	6

Use a Leg Kit when overall bridge length must be greater than 120". Pick based on number of steps and place between Bridge Spans so that no span exceeds 120" between Ladders, Turn Platforms, or Leg Kits.

## U-DESIGN MAX-ACCESS PLATFORMS

The Max-Access Platforms allow you to design your own complete platform and ladder configuration to suit any application where work is being done at height. The platform components can be used together for more width or length. You can create a custom multi-tiered system by using the various ladder and stair components available. The versatility of the platforms' ability of being connected to any other component truly gives you the maximum access options!

### Features:

- Lightweight aluminum construction
- Gray and yellow powder-coated finish
- Serrated grating platform surface and stair treads
- Perforated non-slip ladder rungs
- 750 lb. rated capacity

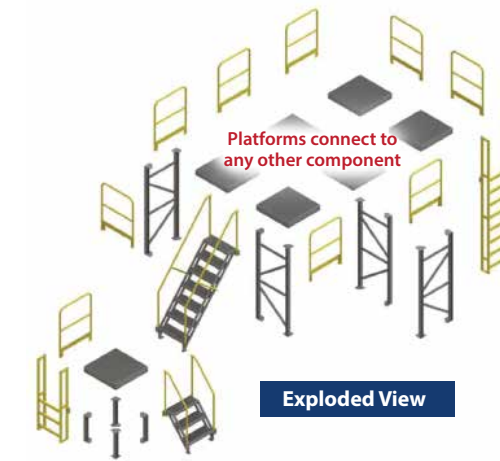

Exploded View

### Example Configuration

- Platform components can be used together for more width or length
- Stairs or Ladders can connect different levels to create multi-tiered systems
- Foot plates have holes for anchoring down

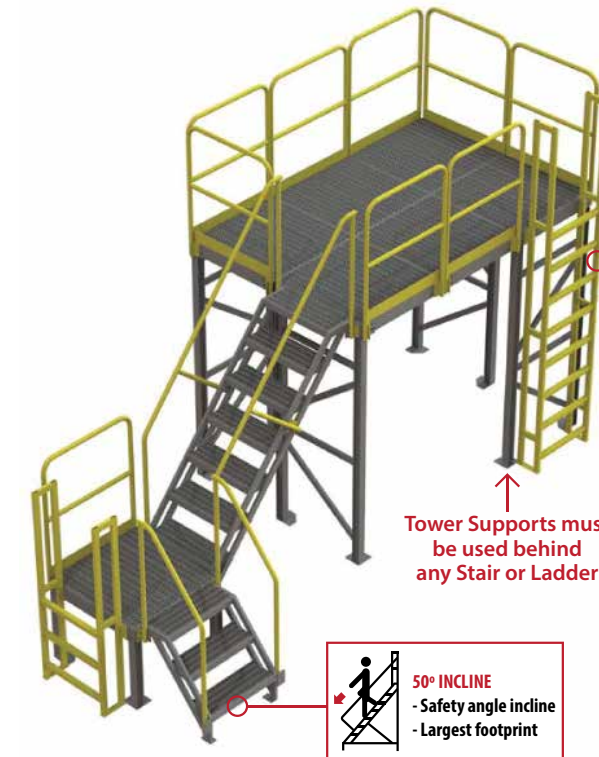

Tower Supports must be used behind any Stair or Ladder



STAIR UNIT - 50° INCLINE							
SERRATED							
# of Steps	Tri-Arc Model #	Step Width	Step Depth	Platform Height	Overall Height	Overall Width	Overall Depth
2	UAP0250	26"	9.5"	20"	59.5"	34"	18.5"
3	UAP0350	26"	9.5"	30"	69.5"	34"	27.0"
4	UAP0450	26"	9.5"	40"	79.5"	34"	35.5"
5	UAP0550	26"	9.5"	50"	89.5"	34"	44.0"
6	UAP0650	26"	9.5"	60"	99.5"	34"	52.0"
7	UAP0750	26"	9.5"	70"	109.5"	34"	60.5"
8	UAP0850	26"	9.5"	80"	119.5"	34"	69.0"
9	UAP0950	26"	9.5"	90"	129.5"	34"	77.5"
10	UAP1050	26"	9.5"	100"	139.5"	34"	85.5"
11	UAP1150	26"	9.5"	110"	149.5"	34"	94.0"

TOWER SUPPORT		
Tri-Arc Model #	For Platform Height of	
UAP020	20"	
UAP030	30"	
UAP040	40"	
UAP050	50"	Tower Supports required with: • Every 50' and 90' ladder • When 3 Platform Units are combined (every 108")
UAP060	60"	
UAP070	70"	
UAP080	80"	
UAP090	90"	
UAP100	100"	
UAP110	110"	

LADDER UNIT - 90° INCLINE							
PERFORATED							
# of Steps	Tri-Arc Model #	Step Width	Step Depth	Platform Height	Overall Height	Overall Width	Overall Depth
2	UAP0290	24"	1.625"	20"	62"	30"	9"
3	UAP0390	24"	1.625"	30"	72"	30"	9"
4	UAP0490	24"	1.625"	40"	82"	30"	9"
5	UAP0590	24"	1.625"	50"	92"	30"	9"
6	UAP0690	24"	1.625"	60"	102"	30"	9"
7	UAP0790	24"	1.625"	70"	112"	30"	9"
8	UAP0890	24"	1.625"	80"	122"	30"	9"
9	UAP0990	24"	1.625"	90"	132"	30"	9"
10	UAP1090	24"	1.625"	100"	142"	30"	9"
11	UAP1190	24"	1.625"	110"	152"	30"	9"

PLATFORM UNIT			
Tri-Arc Model #	Length	Width	Thickness
UAP3636	36"	36"	5"

HANDRAIL	
Tri-Arc Model #	Top Rail Height
UAPHR1	42"

## U-DESIGN MULTI-PLATFORM ACCESS SYSTEM

The Multi-Platform Access System allows you to design your own complete platform and ladder configuration to suit any application where work is being done at height. The platform components can be used together for more width or length. You can create a custom multi-tiered system by using the various ladder and stair components available. The versatility of the platforms' ability of being connected to any other component truly gives you the multi-platform access options!

### Features:

- Aluminum construction
- Unpainted mill finish
- 500 lb. capacity
- 81" Maximum height for all configurations
- Clearance height is 4" less than platform height
- Serrated slip-resistant tread
- Assembly hardware included
- Floor mounting hardware not included / 8" mounting hardware)

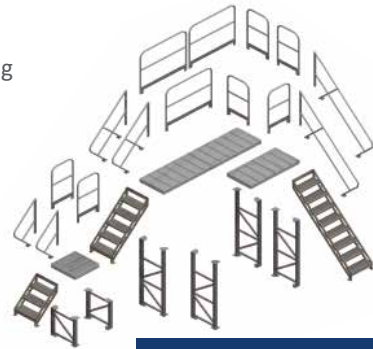

Exploded View

### Example Configuration

**STAIRWAY LADDER HANDRAILS**  
- Fastens to left or right side of stairway ladders  
- Must be ordered to match stairway ladder height

**GUARDRAILS**  
- Available 30" and 60" lengths  
- Additional guardrails can be added to cover longer lengths  
- 42" top rail height  
- 4" kick plate

**PLATFORMS**  
- 30" Width  
- 30", 60", 90" or 120" Length Platforms  
- Each platform section requires support legs on each end  
- Fastens to stairway ladders, Guardrails and support legs

**PLATFORM SUPPORT LEGS**  
- Clears obstructions 14"-77"  
- 9" Height increments  
- Must be ordered to match platform and stairway ladder height  
- Requires mounting to floor surface (hardware not included)

**STAIRWAY LADDER**  
- 45° Incline  
- 24" Wide steps  
- 9" height increments between stairs  
- 18"-81" height range  
- Handrails sold separately  
- Support Legs not required  
- Requires mounting to floor surface (hardware not included)  
- Can be used to enter/exit an elevated platform or to connect two platforms of different heights

### STAIRWAY LADDERS - 45° INCLINE

Tri-Arc Model #	# of Steps	Top Step Height	Clearance Height	Step Width	Step Depth	Overall Height	Overall Width	Overall Depth
MPASSW2	1	18"	14"	24"	9.5"	18"	29"	10"
MPASSW3	2	27"	23"	24"	9.5"	27"	29"	19"
MPASSW4	3	36"	32"	24"	9.5"	36"	29"	28"
MPASSW5	4	45"	41"	24"	9.5"	45"	29"	37"
MPASSW6	5	54"	50"	24"	9.5"	54"	29"	46"
MPASSW7	6	63"	59"	24"	9.5"	63"	29"	55"
MPASSW8	7	72"	68"	24"	9.5"	72"	29"	64"
MPASSW9	8	81"	77"	24"	9.5"	81"	29"	73"

### STAIR UNIT HANDRAILS

Tri-Arc Model #	For Stair Unit	Railing Height
MPASHR2	MPASSW2	36.5"
MPASHR3	MPASSW3	36.5"
MPASHR4	MPASSW4	36.5"
MPASHR5	MPASSW5	36.5"
MPASHR6	MPASSW6	36.5"
MPASHR7	MPASSW7	36.5"
MPASHR8	MPASSW8	36.5"
MPASHR9	MPASSW9	36.5"

### PLATFORM UNITS

Tri-Arc Model #	Length	Width
MPASP30	30"	30"
MPASP60	60"	30"
MPASP90	90"	30"
MPASP120	120"	30"

### PLATFORM GUARDRAILS

Tri-Arc Model #	Length	Width
MPASGR30	30"	42"
MPASGR60	60"	42"

### PLATFORM SUPPORT LEGS

Tri-Arc Model #	For Platform Height
MPASST2	18"
MPASST3	27"
MPASST4	36"
MPASST5	45"
MPASST6	54"
MPASST7	63"
MPASST8	72"
MPASST9	81"

# TRIOARC

Standard Ladders & Work Platforms

## ROLLING LADDERS

Steel Rolling Ladder



Deep Top



Heavy-Duty



All-Directional



Gateway Rear-Exit



Tilt & Roll



Roll & Fold



Stock Picking



Aluminum



Aluminum Wheelbarrow-Style



Adjustable-Height



## SAFETY ANGLE STEEL ROLLING LADDERS (50° SAFETY ANGLE INCLINE)

Safety Angle Steel Rolling Ladder



Heavy-Duty



All-Directional



Gateway Exit-Rear Safety Angle



## MOBILE AND STATIONARY WORK PLATFORMS

Double-Sided



Work Platform



Adjustable Height



Anti-Fatigue



Refrigerator Truck Rolling Access



## MOBILE STEP STANDS AND STEP STOOLS

Folding/Rolling Step Stand



Steel Step Stool



Aluminum Step Stool



## FIXED LADDERS

Industrial Access Stairway



Fixed Cage Ladder



Dock Ladder



## STEEL ROLLING LADDER

### Features:

- 450 lb. rated capacity
- Perforated or Grip Strut tread
- Ships unassembled
- 1-1/16" Tubular steel construction
- Powder coat gray finish
- Spring-loaded casters 2 - 5 step models
- Step Lock 6 - 16 step models
- Complies with applicable OSHA & ANSI standards



STEEL ROLLING LADDER							
PERFORATED	GRIP STRUT						
Tri-Arc Model #	Tri-Arc Model #	# of Steps	Step Width	Platform Height	Overall Height	Platform W x L	Base W x D
WITHOUT HANDRAILS							
KDSR002166	KDSR002162	2	16"	20"	20"	16" x 10"	21" x 21"
KDSR002246	KDSR002242	2	24"	20"	20"	24" x 10"	28" x 21"
KDSR003166	KDSR003162	3	16"	30"	30"	16" x 10"	24" x 28"
KDSR003246	KDSR003242	3	24"	30"	30"	24" x 10"	30" x 28"
KDSR004166	KDSR004162	4	16"	40"	40"	16" x 10"	24" x 35"
KDSR004246	KDSR004242	4	24"	40"	40"	24" x 10"	30" x 35"
WITH HANDRAILS							
KDSR102166	KDSR102162	2	16"	20"	56"	16" x 10"	21" x 21"
KDSR102246	KDSR102242	2	24"	20"	56"	24" x 10"	28" x 21"
KDSR103166	KDSR103162	3	16"	30"	66"	16" x 10"	24" x 28"
KDSR103246	KDSR103242	3	24"	30"	66"	24" x 10"	30" x 28"
KDSR104166	KDSR104162	4	16"	40"	76"	16" x 10"	24" x 35"
KDSR104246	KDSR104242	4	24"	40"	76"	24" x 10"	30" x 35"
KDSR105166	KDSR105162	5	16"	50"	86"	16" x 10"	24" x 42"
KDSR105246	KDSR105242	5	24"	50"	86"	24" x 10"	30" x 42"
KDSR106166	KDSR106162	6	16"	60"	96"	16" x 10"	27" x 50"
KDSR106246	KDSR106242	6	24"	60"	96"	24" x 10"	35" x 50"
KDSR107166	KDSR107162	7	16"	70"	106"	16" x 10"	27" x 57"
KDSR107246	KDSR107242	7	24"	70"	106"	24" x 10"	35" x 57"
KDSR108246	KDSR108242	8	24"	80"	116"	24" x 10"	35" x 64"
KDSR109246	KDSR109242	9	24"	90"	126"	24" x 10"	35" x 69"
KDSR110246	KDSR110242	10	24"	100"	136"	24" x 10"	35" x 76"
KDSR111246	KDSR111242	11	24"	110"	146"	24" x 10"	35" x 83"
KDSR112246	KDSR112242	12	24"	120"	156"	24" x 10"	35" x 90"
KDSR113246	KDSR113242	13	24"	130"	166"	24" x 10"	40" x 96"
KDSR114246	KDSR114242	14	24"	140"	176"	24" x 10"	40" x 103"
KDSR115246	KDSR115242	15	24"	150"	186"	24" x 10"	40" x 110"
KDSR116246	KDSR116242	16	24"	160"	196"	24" x 10"	43" x 117"

## ALUMINUM ROLLING LADDER

### Features:

- 350 lb. rated capacity
- Solid Ribbed or Grip Strut tread
- Ships all-welded
- 3/4" Sch. 40, 1-1/16" O.D. pipe
- Standard mill finish
- Spring-loaded casters 2 - 7 step models
- Step Lock 8 - 12 step models
- Complies with applicable OSHA & ANSI standards



ALUMINUM ROLLING LADDER							
WITHOUT HANDRAILS							
RIBBED	GRIP STRUT						
Tri-Arc Model #	Tri-Arc Model #	# of Steps	Step Width	Platform Height	Overall Height	Platform W x L	Base W x D
WLAR002164	WLAR002165	2	16"	20"	20"	16" x 14"	20" x 23"
WLAR002246	WLAR002245	2	24"	20"	20"	24" x 14"	29" x 23"
WLAR003164	WLAR003165	3	16"	30"	30"	16" x 14"	22" x 31"
WLAR003244	WLAR003245	3	24"	30"	30"	24" x 14"	29" x 31"
WLAR004164	WLAR004165	4	16"	40"	40"	16" x 14"	22" x 37"
WLAR004244	WLAR004245	4	24"	40"	40"	24" x 14"	32" x 37"
WITH HANDRAILS							
RIBBED	GRIP STRUT						
Tri-Arc Model #	Tri-Arc Model #	# of Steps	Step Width	Platform Height	Overall Height	Platform W x L	Base W x D
WLAR102164	WLAR102165	2	16"	20"	52"	16" x 14"	20" x 23"
WLAR102244	WLAR102245	2	24"	20"	52"	24" x 14"	29" x 23"
WLAR103164	WLAR103165	3	16"	30"	62"	16" x 14"	22" x 31"
WLAR103244	WLAR103245	3	24"	30"	62"	24" x 14"	29" x 31"
WLAR104164	WLAR104165	4	16"	40"	72"	16" x 14"	22" x 37"
WLAR104244	WLAR104245	4	24"	40"	72"	24" x 14"	32" x 37"
WLAR105164	WLAR105165	5	16"	50"	82"	16" x 14"	22" x 44"
WLAR105244	WLAR105245	5	24"	50"	82"	24" x 14"	32" x 44"
WLAR106164	WLAR106165	6	16"	60"	92"	16" x 14"	26" x 51"
WLAR106244	WLAR106245	6	24"	60"	92"	24" x 14"	32" x 51"
WLAR107164	WLAR107165	7	16"	70"	102"	16" x 14"	26" x 57"
WLAR107244	WLAR107245	7	24"	70"	102"	24" x 14"	32" x 57"
WLAR108244	WLAR108245	8	24"	80"	112"	24" x 14"	36" x 66"
WLAR109244	WLAR109245	9	24"	90"	122"	24" x 14"	36" x 72"
WLAR110244	WLAR110245	10	24"	100"	132"	24" x 14"	36" x 79"
WLAR111244	WLAR111245	11	24"	110"	142"	24" x 14"	38" x 86"
WLAR112244	WLAR112245	12	24"	120"	156"	24" x 14"	38" x 92"



## DEEP TOP STEEL ROLLING LADDER

### Features:

- 20" or 30" Deep top platform
- 450 lb. rated capacity
- Perforated or Grip Strut tread
- Ships unassembled
- 1-1/16" Tubular steel construction
- Powder coat gray finish
- Spring-loaded casters 2 - 4 step models
- Step Lock 5 - 16 step models
- 7" deep steps
- Complies with applicable OSHA & ANSI standards



DEEP TOP STEEL ROLLING LADDER											
RIBBED		GRIP STRUT		# of Steps	Step Width	Platform Height	Overall Height	Platform W x L		Base W x D	
Tri-Arc Model #	Tri-Arc Model #	Tri-Arc Model #	Tri-Arc Model #					20"	30"	20"	30"
20" DEEP TOP	30" DEEP TOP	20" DEEP TOP	30" DEEP TOP	WITHOUT HANDRAILS							
KDSR002166-D2	KDSR002166-D3	KDSR002162-D2	KDSR002162-D3	2	16"	20"	20"	16" x 20"	16" x 30"	21" x 31"	21" x 41"
KDSR002246-D2	KDSR002246-D3	KDSR002242-D2	KDSR002242-D3	2	24"	20"	20"	24" x 20"	24" x 30"	28" x 31"	28" x 41"
KDSR003166-D2	KDSR003166-D3	KDSR003162-D2	KDSR003162-D3	3	16"	30"	30"	16" x 20"	16" x 30"	24" x 38"	24" x 48"
KDSR003246-D2	KDSR003246-D3	KDSR003242-D2	KDSR003242-D3	3	24"	30"	30"	24" x 20"	24" x 30"	30" x 38"	30" x 48"
KDSR004166-D2	KDSR004166-D3	KDSR004162-D2	KDSR004162-D3	4	16"	40"	40"	16" x 20"	16" x 30"	24" x 45"	24" x 55"
KDSR004246-D2	KDSR004246-D3	KDSR004242-D2	KDSR004242-D3	4	24"	40"	40"	24" x 20"	24" x 30"	30" x 45"	30" x 55"
WITH HANDRAILS											
KDSR102166-D2	KDSR102166-D3	KDSR102162-D2	KDSR102162-D3	2	16"	20"	56"	16" x 20"	16" x 30"	21" x 31"	21" x 41"
KDSR102246-D2	KDSR102246-D3	KDSR102242-D2	KDSR102242-D3	2	24"	20"	56"	24" x 20"	24" x 30"	28" x 31"	28" x 41"
KDSR103166-D2	KDSR103166-D3	KDSR103162-D2	KDSR103162-D3	3	16"	30"	66"	16" x 20"	16" x 30"	24" x 38"	24" x 48"
KDSR103246-D2	KDSR103246-D3	KDSR103242-D2	KDSR103242-D3	3	24"	30"	66"	24" x 20"	24" x 30"	30" x 38"	30" x 48"
KDSR104166-D2	KDSR104166-D3	KDSR104162-D2	KDSR104162-D3	4	16"	40"	76"	16" x 20"	16" x 30"	24" x 45"	24" x 55"
KDSR104246-D2	KDSR104246-D3	KDSR104242-D2	KDSR104242-D3	4	24"	40"	76"	24" x 20"	24" x 30"	30" x 45"	30" x 55"
KDSR105166-D2	KDSR105166-D3	KDSR105162-D2	KDSR105162-D3	5	16"	50"	86"	16" x 20"	16" x 30"	24" x 52"	24" x 62"
KDSR105246-D2	KDSR105246-D3	KDSR105242-D2	KDSR105242-D3	5	24"	50"	86"	24" x 20"	24" x 30"	30" x 52"	30" x 62"
KDSR106166-D2	KDSR106166-D3	KDSR106162-D2	KDSR106162-D3	6	16"	60"	96"	16" x 20"	16" x 30"	27" x 60"	27" x 70"
KDSR106246-D2	KDSR106246-D3	KDSR106242-D2	KDSR106242-D3	6	24"	60"	96"	24" x 20"	24" x 30"	35" x 60"	35" x 70"
KDSR107166-D2	KDSR107166-D3	KDSR107162-D2	KDSR107162-D3	7	16"	70"	106"	16" x 20"	16" x 30"	27" x 67"	27" x 77"
KDSR107246-D2	KDSR107246-D3	KDSR107242-D2	KDSR107242-D3	7	24"	70"	106"	24" x 20"	24" x 30"	35" x 67"	35" x 77"
KDSR108246-D2	KDSR108246-D3	KDSR108242-D2	KDSR108242-D3	8	24"	80"	116"	24" x 20"	24" x 30"	35" x 74"	35" x 84"
KDSR109246-D2	KDSR109246-D3	KDSR109242-D2	KDSR109242-D3	9	24"	90"	126"	24" x 20"	24" x 30"	35" x 79"	35" x 89"
KDSR110246-D2	KDSR110246-D3	KDSR110242-D2	KDSR110242-D3	10	24"	100"	136"	24" x 20"	24" x 30"	35" x 86"	35" x 96"
KDSR111246-D2	KDSR111246-D3	KDSR111242-D2	KDSR111242-D3	11	24"	110"	146"	24" x 20"	24" x 30"	35" x 93"	35" x 103"
KDSR112246-D2	KDSR112246-D3	KDSR112242-D2	KDSR112242-D3	12	24"	120"	156"	24" x 20"	24" x 30"	35" x 100"	35" x 110"
KDSR113246-D2	KDSR113246-D3	KDSR113242-D2	KDSR113242-D3	13	24"	130"	166"	24" x 20"	24" x 30"	40" x 106"	40" x 116"
KDSR114246-D2	KDSR114246-D3	KDSR114242-D2	KDSR114242-D3	14	24"	140"	176"	24" x 20"	24" x 30"	40" x 113"	40" x 123"
KDSR115246-D2	KDSR115246-D3	KDSR115242-D2	KDSR115242-D3	15	24"	150"	186"	24" x 20"	24" x 30"	40" x 120"	40" x 130"
KDSR116246-D2	KDSR116246-D3	KDSR116242-D2	KDSR116242-D3	16	24"	160"	196"	24" x 20"	24" x 30"	43" x 127"	43" x 137"

## DEEP TOP ALUMINUM ROLLING LADDER

### Features:

- 21" or 28" Deep top platform
- 350 lb. rated capacity
- Solid Ribbed or Grip Strut tread
- Ships all-welded
- 3/4" Sch. 40, 1-1/16" O.D. pipe
- Standard mill finish
- Spring-loaded casters 2 - 7 step models
- Step Lock 8 - 12 step models
- Complies with applicable OSHA & ANSI standards



DEEP TOP ALUMINUM ROLLING LADDER											
RIBBED		GRIP STRUT		# of Steps	Step Width	Platform Height	Overall Height	Platform W x L		Base W x D	
Tri-Arc Model #	Tri-Arc Model #	Tri-Arc Model #	Tri-Arc Model #					21"	28"	21"	28"
21" DEEP TOP	28" DEEP TOP	21" DEEP TOP	28" DEEP TOP	WITHOUT HANDRAILS							
WLAR002164-D4	WLAR002164-D5	WLAR002165-D4	WLAR002165-D5	2	16"	20"	20"	16" x 21"	16" x 28"	20" x 30"	20" x 37"
WLAR002264-D4	WLAR002264-D5	WLAR002265-D4	WLAR002265-D5	2	24"	20"	20"	24" x 21"	24" x 28"	29" x 30"	29" x 37"
WLAR003164-D4	WLAR003164-D5	WLAR003165-D4	WLAR003165-D5	3	16"	30"	30"	16" x 21"	16" x 28"	22" x 38"	22" x 45"
WLAR003244-D4	WLAR003244-D5	WLAR003245-D4	WLAR003245-D5	3	24"	30"	30"	24" x 21"	24" x 28"	29" x 38"	29" x 45"
WLAR004164-D4	WLAR004164-D5	WLAR004165-D4	WLAR004165-D5	4	16"	40"	40"	16" x 21"	16" x 28"	22" x 44"	22" x 51"
WLAR004244-D4	WLAR004244-D5	WLAR004245-D4	WLAR004245-D5	4	24"	40"	40"	24" x 21"	24" x 28"	32" x 44"	32" x 51"
WITH HANDRAILS											
WLAR102164-D4	WLAR102164-D5	WLAR102165-D4	WLAR102165-D5	2	16"	20"	52"	16" x 21"	16" x 28"	20" x 30"	20" x 37"
WLAR102244-D4	WLAR102244-D5	WLAR102245-D4	WLAR102245-D5	2	24"	20"	52"	24" x 21"	24" x 28"	29" x 30"	29" x 37"
WLAR103164-D4	WLAR103164-D5	WLAR103165-D4	WLAR103165-D5	3	16"	30"	62"	16" x 21"	16" x 28"	22" x 38"	22" x 45"
WLAR103244-D4	WLAR103244-D5	WLAR103245-D4	WLAR103245-D5	3	24"	30"	62"	24" x 21"	24" x 28"	29" x 38"	29" x 45"
WLAR104164-D4	WLAR104164-D5	WLAR104165-D4	WLAR104165-D5	4	16"	40"	72"	16" x 21"	16" x 28"	22" x 44"	22" x 51"
WLAR104244-D4	WLAR104244-D5	WLAR104245-D4	WLAR104245-D5	4	24"	40"	72"	24" x 21"	24" x 28"	32" x 44"	32" x 51"
WLAR105164-D4	WLAR105164-D5	WLAR105165-D4	WLAR105165-D5	5	16"	50"	82"	16" x 21"	16" x 28"	22" x 51"	22" x 58"
WLAR105244-D4	WLAR105244-D5	WLAR105245-D4	WLAR105245-D5	5	24"	50"	82"	24" x 21"	24" x 28"	32" x 51"	32" x 58"
WLAR106164-D4	WLAR106164-D5	WLAR106165-D4	WLAR106165-D5	6	16"	60"	92"	16" x 21"	16" x 28"	26" x 58"	26" x 65"
WLAR106244-D4	WLAR106244-D5	WLAR106245-D4	WLAR106245-D5	6	24"	60"	92"	24" x 21"	24" x 28"	32" x 58"	32" x 65"
WLAR107164-D4	WLAR107164-D5	WLAR107165-D4	WLAR107165-D5	7	16"	70"	102"	16" x 21"	16" x 28"	26" x 64"	26" x 71"
WLAR107244-D4	WLAR107244-D5	WLAR107245-D4	WLAR107245-D5	7	24"	70"	102"	24" x 21"	24" x 28"	32" x 64"	32" x 71"
WLAR108244-D4	WLAR108244-D5	WLAR108245-D4	WLAR108245-D5	8	24"	80"	112"	24" x 21"	24" x 28"	36" x 72"	36" x 79"
WLAR109244-D4	WLAR109244-D5	WLAR109245-D4	WLAR109245-D5	9	24"	90"	122"	24" x 21"	24" x 28"	36" x 79"	36" x 86"
WLAR110244-D4	WLAR110244-D5	WLAR110245-D4	WLAR110245-D5	10	24"	100"	132"	24" x 21"	24" x 28"	36" x 86"	36" x 93"
WLAR111244-D4	WLAR111244-D5	WLAR111245-D4	WLAR111245-D5	11	24"	110"	142"	24" x 21"	24" x 28"	38" x 93"	38" x 100"
WLAR112244-D4	WLAR112244-D5	WLAR112245-D4	WLAR112245-D5	12	24"	120"	156"	24" x 21"	24" x 28"	38" x 99"	38" x 106"

# 600# HEAVY-DUTY ROLLING LADDER

**Features:**

- 600 lb. rated capacity
- Additional bracing
- Perforated or Grip Strut tread
- Ships unassembled
- 1-1/16" Tubular steel construction
- Powder coat gray finish
- Step Lock all models
- Complies with applicable OSHA & ANSI standards



600# HEAVY-DUTY ROLLING LADDER							
PERFORATED	GRIP STRUT	# of Steps	Step Width	Platform Height	Overall Height	Platform W x L	Base W x D
Tri-Arc Model #	Tri-Arc Model #						
KDHD106246	KDHD106242	6	24"	60"	96"	24" x 10"	35" x 50"
KDHD107246	KDHD107242	7	24"	70"	106"	24" x 10"	35" x 57"
KDHD108246	KDHD108242	8	24"	80"	116"	24" x 10"	35" x 64"
KDHD109246	KDHD109242	9	24"	90"	126"	24" x 10"	35" x 69"
KDHD110246	KDHD110242	10	24"	100"	136"	24" x 10"	35" x 76"
KDHD111246	KDHD111242	11	24"	110"	146"	24" x 10"	35" x 83"
KDHD112246	KDHD112242	12	24"	120"	156"	24" x 10"	35" x 90"

# ALL-DIRECTIONAL ROLLING LADDER

**Ideal for ease of maneuvering in tight spaces or narrow aisles.**

**Features:**

- LADDER TURNS WITHIN ITS OWN RADIUS
- 450 lb. rated capacity
- Perforated or Grip Strut tread
- Ships unassembled
- 1-1/16" Tubular steel rails
- Powder coat gray finish
- Step Lock all models
- Complies with applicable OSHA & ANSI standards



ALL-DIRECTIONAL ROLLING LADDER							
PERFORATED	GRIP STRUT	# of Steps	Step Width	Platform Height	Overall Height	Platform W x L	Base W x L
Tri-Arc Model #	Tri-Arc Model #						
KDED107246	KDED107242	7	24"	70"	106"	24" x 10"	35" x 57"
KDED108246	KDED108242	8	24"	80"	116"	24" x 10"	35" x 64"
KDED109246	KDED109242	9	24"	90"	126"	24" x 10"	35" x 69"
KDED110246	KDED110242	10	24"	100"	136"	24" x 10"	35" x 76"
KDED111246	KDED111242	11	24"	110"	146"	24" x 10"	35" x 83"
KDED112246	KDED112242	12	24"	120"	156"	24" x 10"	35" x 90"
KDED113246	KDED113242	13	24"	130"	166"	24" x 10"	40" x 96"
KDED114246	KDED114242	14	24"	140"	176"	24" x 10"	40" x 103"
KDED115246	KDED115242	15	24"	150"	186"	24" x 10"	40" x 110"
KDED116246	KDED116242	16	24"	160"	196"	24" x 10"	43" x 117"

## GATEWAY REAR-EXIT ROLLING LADDER

The first ever rolling ladder with an rear-exit gate that allows you to exit the ladder onto an elevated surface!

### Features:

- Large 30" deep top platform
- 450 lb. rated capacity
- Perforated or Grip Strut tread
- Ships unassembled
- 1-1/16" Tubular steel construction
- Powder coat gray finish
- Step Lock standard on all models
- Complies with applicable OSHA & ANSI standards

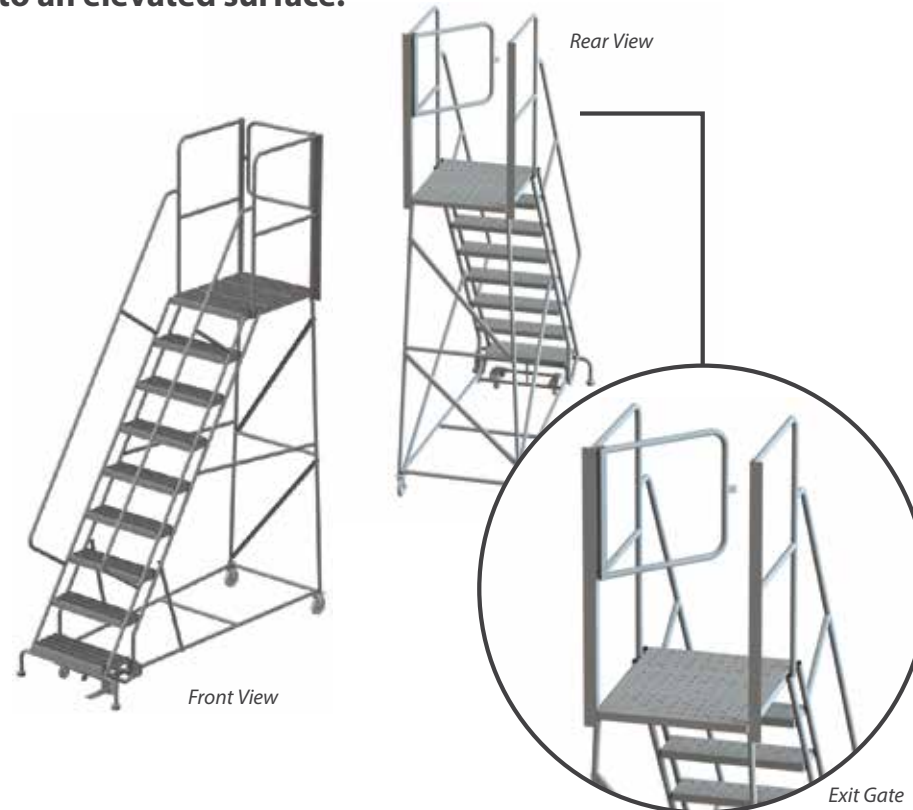

### GATEWAY REAR-EXIT ROLLING LADDER

PERFORATED		GRIP STRUT		# of Steps	Step Width	Platform Height	Overall Height	Platform W x L	Base W x D
Tri-Arc Model #	Tri-Arc Model #	Tri-Arc Model #	Tri-Arc Model #						
<b>WITH HANDRAILS</b>									
RWSR106246-XR	RWSR106242-XR	6	24"	60"	100"	24" x 30"	35" x 70"		
RWSR107246-XR	RWSR107242-XR	7	24"	70"	110"	24" x 30"	35" x 77"		
RWSR108246-XR	RWSR108242-XR	8	24"	80"	120"	24" x 30"	35" x 84"		
RWSR109246-XR	RWSR109242-XR	9	24"	90"	130"	24" x 30"	35" x 89"		
RWSR110246-XR	RWSR110242-XR	10	24"	100"	140"	24" x 30"	35" x 96"		
RWSR111246-XR	RWSR111242-XR	11	24"	110"	150"	24" x 30"	35" x 103"		
RWSR112246-XR	RWSR112242-XR	12	24"	120"	160"	24" x 30"	35" x 110"		
RWSR113246-XR	RWSR113242-XR	13	24"	130"	170"	24" x 30"	40" x 116"		
RWSR114246-XR	RWSR114242-XR	14	24"	140"	180"	24" x 30"	40" x 123"		
RWSR115246-XR	RWSR115242-XR	15	24"	150"	190"	24" x 30"	40" x 130"		

## TILT & ROLL LADDER

### Features:

- 450 lb. rated capacity
- Perforated or Grip Strut tread
- Ships unassembled
- 1-1/16" Tubular steel construction
- Powder coat gray finish
- Complies with applicable OSHA & ANSI standards



### TILT & ROLL LADDER

PERFORATED		GRIP STRUT		# of Steps	Step Width	Platform Height	Overall Height	Platform W x L	Base W x D
Tri-Arc Model #	Tri-Arc Model #	Tri-Arc Model #	Tri-Arc Model #						
<b>WITH HANDRAILS</b>									
KDTF102166	KDTF102162	2	16"	20"	56"	16" x 10"	23" x 23"		
KDTF102246	KDTF102242	2	24"	20"	56"	24" x 10"	31" x 23"		
KDTF103166	KDTF103162	3	16"	30"	66"	16" x 10"	24" x 30"		
KDTF103246	KDTF103242	3	24"	30"	66"	24" x 10"	31" x 30"		
KDTF104166	KDTF104162	4	16"	40"	76"	16" x 10"	24" x 37"		
KDTF104246	KDTF104242	4	24"	40"	76"	24" x 10"	31" x 37"		
KDTF105166	KDTF105162	5	16"	50"	86"	16" x 10"	24" x 44"		
KDTF105246	KDTF105242	5	24"	50"	86"	24" x 10"	31" x 44"		
KDTF106166	KDTF106162	6	16"	60"	96"	16" x 10"	27" x 52"		
KDTF106246	KDTF106242	6	24"	60"	96"	24" x 10"	35" x 52"		
KDTF107166	KDTF107162	7	16"	70"	106"	16" x 10"	31" x 59"		
KDTF107246	KDTF107242	7	24"	70"	106"	24" x 10"	37" x 59"		

## ALL-TERRAIN ROLLING LADDERS

### Features:

- 10" Semi-pneumatic wheels
- 450 lb. rated capacity
- Perforated or Grip Strut tread
- Ships unassembled
- 1-1/16" Tubular steel construction
- Powder coat gray finish
- Complies with applicable OSHA & ANSI standards



ALL-TERRAIN ROLLING LADDER							
PERFORATED	GRIP STRUT	# of Steps	Step Width	Platform Height	Overall Height	Platform W x L	Base W x D
Tri-Arc Model #	Tri-Arc Model #						
KDRF103166	KDRF103162	3	16"	30"	66"	16" x 10"	29" x 32.5"
KDRF104166	KDRF104162	4	16"	40"	76"	16" x 10"	29" x 39.5"
KDRF105166	KDRF105162	5	16"	50"	86"	16" x 10"	31" x 46.5"
KDRF106166	KDRF106162	6	16"	60"	96"	16" x 10"	31" x 54.5"
KDRF107166	KDRF107162	7	16"	70"	106"	16" x 10"	31" x 61.5"
KDRF108166	KDRF108162	8	16"	80"	116"	16" x 10"	37" x 68.5"
KDRF109166	KDRF109162	9	16"	90"	126"	16" x 10"	37" x 73.5"
KDRF110166	KDRF110162	10	16"	100"	136"	16" x 10"	37" x 80.5"
KDRF111166	KDRF111162	11	16"	110"	146"	16" x 10"	37" x 87.5"
KDRF112166	KDRF112162	12	16"	120"	156"	16" x 10"	37" x 94.5"

## STOCK PICKING ROLLING LADDER

### Features:

- 2 Shelves 6 - 7 step models
- 3 Shelves 8 - 12 step models
- 20" Deep top platform
- 450 lb. rated capacity
- Perforated or Grip Strut tread
- Ships unassembled
- 1-1/16" Tubular steel construction
- Powder coat gray finish
- Step Lock 6 - 12 step models
- Complies with applicable OSHA & ANSI standards



STOCK PICKING ROLLING LADDER							
PERFORATED	GRIP STRUT	# of Steps	Step Width	Platform Height	Overall Height	Platform W x L	Base W x D
Tri-Arc Model #	Tri-Arc Model #						
KDSP106246	KDSP106242	6	24"	60"	96"	24" x 20"	35" x 60"
KDSP107246	KDSP107242	7	24"	70"	106"	24" x 20"	35" x 66"
KDSP108246	KDSP108242	8	24"	80"	116"	24" x 20"	35" x 73"
KDSP109246	KDSP109242	9	24"	90"	126"	24" x 20"	35" x 78"
KDSP110246	KDSP110242	10	24"	100"	136"	24" x 20"	35" x 85"
KDSP111246	KDSP111242	11	24"	110"	146"	24" x 20"	35" x 92"
KDSP112246	KDSP112242	12	24"	120"	156"	24" x 20"	35" x 99"

## ALUMINUM WHEELBARROW-STYLE LADDER

### Features:

- 10" Semi-Pneumatic Wheels
- 350 lb. rated capacity
- Solid Ribbed or Grip Strut tread
- Ships all-welded
- 3/4" Sch. 40, 1-1/16" O.D. Pipe
- Standard mill finish
- Complies with applicable OSHA & ANSI standards



ALUMINUM WHEELBARROW-STYLE LADDER							
RIBBED	GRIP STRUT						
Tri-Arc Model #	Tri-Arc Model #	# of Steps	Step Width	Platform Height	Overall Height	Platform W x L	Base W x D
WLARTR105164	WLARTR105165	5	16"	50"	82"	16" x 14"	27" x 48.5"
WLARTR105244	WLARTR105245	5	24"	50"	82"	24" x 14"	37" x 48.5"
WLARTR106164	WLARTR106165	6	16"	60"	92"	16" x 14"	31" x 55.5"
WLARTR106244	WLARTR106245	6	24"	60"	92"	24" x 14"	37" x 55.5"
WLARTR107164	WLARTR107165	7	16"	70"	102"	16" x 14"	31" x 61.5"
WLARTR107244	WLARTR107245	7	24"	70"	102"	24" x 14"	37" x 61.5"
WLARTR108244	WLARTR108245	8	24"	80"	112"	24" x 14"	37" x 70.5"
WLARTR109244	WLARTR109245	9	24"	90"	122"	24" x 14"	37" x 76.5"
WLARTR110244	WLARTR110245	10	24"	100"	132"	24" x 14"	40" x 83.5"

## ADJUSTABLE-HEIGHT MOBILE LADDER

### Features:

- Steps articulate as height adjusts
- 50"-90" and 80"-120" range models
- Powered and manual models
- 500 lb. rated capacity
- Diamond plate platform surface
- Serrated 11-3/4" deep steps
- 42" guardrails
- Removable chains on right & left guardrails
- 8"x2" Locking casters
- Hybrid aluminum and steel construction
- Complies with applicable OSHA & ANSI standards



ADJUSTABLE-HEIGHT MOBILE LADDER							
Tri-Arc Model #	For Step Sizes	Adjustment Range	Overall Height Range	Stowed Height	Platform W x L	Overall Width	Overall Length
<b>MANUAL HYDRAULIC PUMP</b>							
ALS5090-M	9	50" - 90"	92" - 132"	94"	24" x 48"	48"	147"
ALS80120-M	12	80" - 120"	122" - 162"	122"	24" x 48"	48"	178"
<b>SHOP AIR POWERED HYDRAULIC PUMP</b>							
ALS5090-A	9	50" - 90"	92" - 132"	94"	24" x 48"	48"	147"
ALS80120-A	12	80" - 120"	122" - 162"	122"	24" x 48"	48"	178"

## SAFETY ANGLE ROLLING LADDER

### Features:

- 17" deep top platform
- 50° Safety angle incline
- 450 lb. rated capacity
- Perforated or Grip Strut tread
- Ships unassembled
- 1-1/16" tubular steel rails
- 1" x 2" reinforced back & bottom frame
- 8.5" Deep steps, 10" deep 1st step
- Powder coat gray finish
- Step Lock all models
- Complies with applicable OSHA & ANSI standards



SAFETY ANGLE ROLLING LADDER							
PERFORATED	GRIP STRUT	# of Steps	Step Width	Platform Height	Overall Height	Platform W x L	Base W x D
Tri-Arc Model #	Tri-Arc Model #						
KDEC103166	KDEC103162	3	16"	30"	66"	16" x 17"	27" x 41"
KDEC103246	KDEC103242	3	24"	30"	66"	24" x 17"	35" x 41"
KDEC104166	KDEC104162	4	16"	40"	76"	16" x 17"	27" x 49"
KDEC104246	KDEC104242	4	24"	40"	76"	24" x 17"	35" x 49"
KDEC105166	KDEC105162	5	16"	50"	86"	16" x 17"	27" x 58"
KDEC105246	KDEC105242	5	24"	50"	86"	24" x 17"	35" x 58"
KDEC106166	KDEC106162	6	16"	60"	96"	16" x 17"	27" x 66"
KDEC106246	KDEC106242	6	24"	60"	96"	24" x 17"	35" x 66"
KDEC107166	KDEC107162	7	16"	70"	106"	16" x 17"	27" x 74"
KDEC107246	KDEC107242	7	24"	70"	106"	24" x 17"	35" x 74"
KDEC108246	KDEC108242	8	24"	80"	116"	24" x 17"	35" x 82"
KDEC109246	KDEC109242	9	24"	90"	126"	24" x 17"	35" x 91"
KDEC110246	KDEC110242	10	24"	100"	136"	24" x 17"	35" x 99"
KDEC111246	KDEC111242	11	24"	110"	146"	24" x 17"	35" x 107"
KDEC112246	KDEC112242	12	24"	120"	156"	24" x 17"	35" x 116"
KDEC113246	KDEC113242	13	24"	130"	166"	24" x 17"	40" x 124"
KDEC114246	KDEC114242	14	24"	140"	176"	24" x 17"	40" x 132"
KDEC115246	KDEC115242	15	24"	150"	186"	24" x 17"	40" x 141"
KDEC116246	KDEC116242	16	24"	160"	196"	24" x 17"	43" x 149"

## SAFETY ANGLE ROLLING LADDER

### Features:

- 17" deep top platform
- 50° Safety angle incline
- 450 lb. rated capacity
- Perforated or Grip Strut tread
- Ships unassembled
- 1-1/16" tubular steel rails
- 1" x 2" reinforced back & bottom frame
- 8.5" Deep steps, 10" deep 1st step
- Safety Yellow finish
- Step Lock all models
- Complies with applicable OSHA & ANSI standards



SAFETY ANGLE ROLLING LADDER							
PERFORATED	GRIP STRUT	# of Steps	Step Width	Platform Height	Overall Height	Platform W x L	Base W x D
Tri-Arc Model #	Tri-Arc Model #						
KDEC103166-Y	KDEC103162-Y	3	16"	30"	66"	16" x 17"	27" x 41"
KDEC103246-Y	KDEC103242-Y	3	24"	30"	66"	24" x 17"	35" x 41"
KDEC104166-Y	KDEC104162-Y	4	16"	40"	76"	16" x 17"	27" x 49"
KDEC104246-Y	KDEC104242-Y	4	24"	40"	76"	24" x 17"	35" x 49"
KDEC105166-Y	KDEC105162-Y	5	16"	50"	86"	16" x 17"	27" x 58"
KDEC105246-Y	KDEC105242-Y	5	24"	50"	86"	24" x 17"	35" x 58"
KDEC106166-Y	KDEC106162-Y	6	16"	60"	96"	16" x 17"	27" x 66"
KDEC106246-Y	KDEC106242-Y	6	24"	60"	96"	24" x 17"	35" x 66"
KDEC107166-Y	KDEC107162-Y	7	16"	70"	106"	16" x 17"	27" x 74"
KDEC107246-Y	KDEC107242-Y	7	24"	70"	106"	24" x 17"	35" x 74"
KDEC108246-Y	KDEC108242-Y	8	24"	80"	116"	24" x 17"	35" x 82"
KDEC109246-Y	KDEC109242-Y	9	24"	90"	126"	24" x 17"	35" x 91"
KDEC110246-Y	KDEC110242-Y	10	24"	100"	136"	24" x 17"	35" x 99"
KDEC111246-Y	KDEC111242-Y	11	24"	110"	146"	24" x 17"	35" x 107"
KDEC112246-Y	KDEC112242-Y	12	24"	120"	156"	24" x 17"	35" x 116"
KDEC113246-Y	KDEC113242-Y	13	24"	130"	166"	24" x 17"	40" x 124"
KDEC114246-Y	KDEC114242-Y	14	24"	140"	176"	24" x 17"	40" x 132"
KDEC115246-Y	KDEC115242-Y	15	24"	150"	186"	24" x 17"	40" x 141"
KDEC116246-Y	KDEC116242-Y	16	24"	160"	196"	24" x 17"	43" x 149"

# 600# HEAVY-DUTY SAFETY ANGLE ROLLING LADDER

**Features:**

- 600 lb. rated capacity
- Additional bracing
- Safety Angle incline
- Perforated or Grip Strut tread
- Ships unassembled
- 1-1/16" Tubular steel construction
- 1" x 2" Reinforced back & bottom frame
- Powder coat gray finish
- Step Lock all models
- Complies with applicable OSHA & ANSI standards



600# HEAVY-DUTY SAFETY ANGLE ROLLING LADDER							
PERFORATED	GRIP STRUT						
Tri-Arc Model #	Tri-Arc Model #	# of Steps	Step Width	Platform Height	Overall Height	Platform W x L	Base W x D
KDHS106246	KDHS106242	6	24"	60"	96"	24" x 17"	35" x 66"
KDHS107246	KDHS107242	7	24"	70"	106"	24" x 17"	35" x 74"
KDHS108246	KDHS108242	8	24"	80"	116"	24" x 17"	35" x 82"
KDHS109246	KDHS109242	9	24"	90"	126"	24" x 17"	35" x 91"
KDHS110246	KDHS110242	10	24"	100"	136"	24" x 17"	35" x 99"
KDHS111246	KDHS111242	11	24"	110"	146"	24" x 17"	35" x 107"
KDHS112246	KDHS112242	12	24"	120"	156"	24" x 17"	35" x 116"

# ALL-DIRECTIONAL SAFETY ANGLE ROLLING LADDER

Ideal for ease of maneuvering in tight spaces or narrow aisles.

**Features:**

- LADDER TURNS WITHIN ITS OWN RADIUS
- 17" Deep top platform
- Forward descent 50-degree incline
- 450 lb. rated capacity
- Perforated or Grip Strut tread
- Ships unassembled
- 1-1/16" Tubular steel rails
- 1" x 2" Reinforced back & bottom frame
- 8.5" Deep steps, 10" deep 1st step
- Powder coat gray finish
- Step Lock all models
- Complies with applicable OSHA & ANSI standards



ALL-DIRECTIONAL SAFETY ANGLE ROLLING LADDER							
PERFORATED	GRIP STRUT						
Tri-Arc Model #	Tri-Arc Model #	# of Steps	Step Width	Platform Height	Overall Height	Platform W x L	Base W x L
KDAD107246	KDAD107242	7	24"	70"	106"	24" x 17"	35" x 74"
KDAD108246	KDAD108242	8	24"	80"	116"	24" x 17"	35" x 82"
KDAD109246	KDAD109242	9	24"	90"	126"	24" x 17"	35" x 91"
KDAD110246	KDAD110242	10	24"	100"	136"	24" x 17"	35" x 99"
KDAD111246	KDAD111242	11	24"	110"	146"	24" x 17"	35" x 107"
KDAD112246	KDAD112242	12	24"	120"	156"	24" x 17"	35" x 116"
KDAD113246	KDAD113242	13	24"	130"	166"	24" x 17"	40" x 124"
KDAD114246	KDAD114242	14	24"	140"	176"	24" x 17"	40" x 132"
KDAD115246	KDAD115242	15	24"	150"	186"	24" x 17"	40" x 141"
KDAD116246	KDAD116242	16	24"	160"	196"	24" x 17"	43" x 149"

## GATEWAY REAR-EXIT SAFETY ANGLE STEEL ROLLING LADDER

The first ever rolling ladder with an rear-exit gate that allows you to exit the ladder onto an elevated surface!

### Features:

- Large 27" deep top platform
- 50° Safety angle incline
- 450 lb. rated capacity
- Perforated or Grip Strut tread
- Ships unassembled
- 1-1/16" Tubular steel construction
- Powder coat gray finish
- Step Lock standard on all models
- Complies with applicable OSHA & ANSI standards

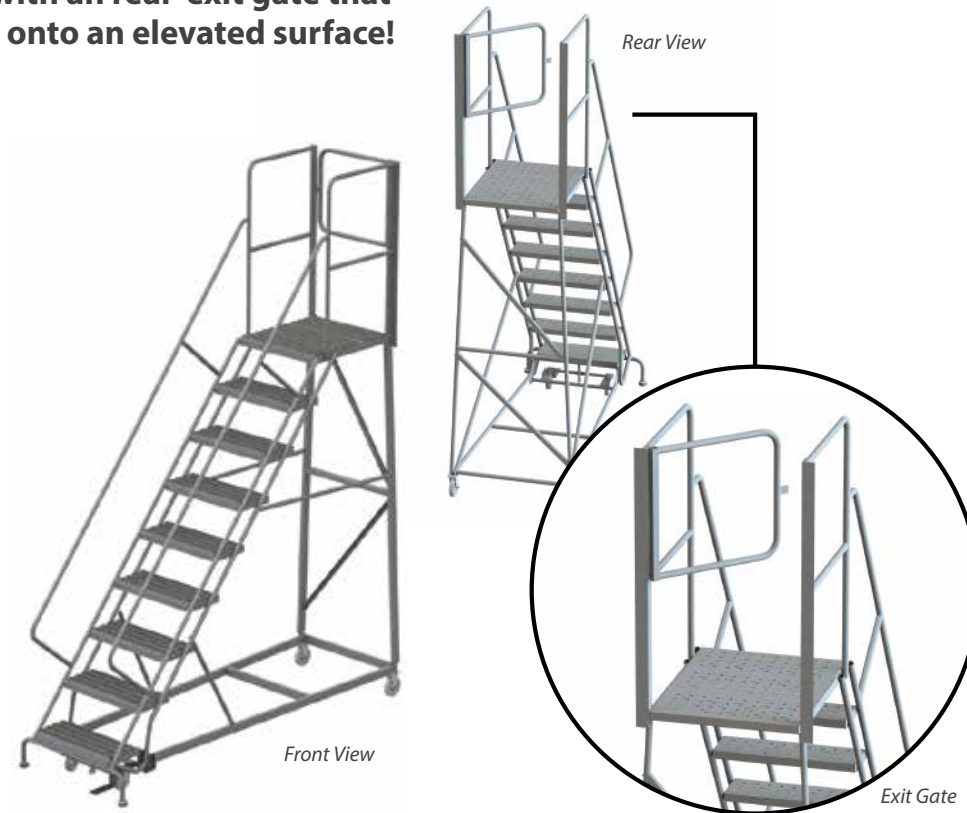

GATEWAY REAR-EXIT SAFETY ANGLE STEEL ROLLING LADDER							
PERFORATED	GRIP STRUT	# of Steps	Step Width	Platform Height	Overall Height	Platform W x L	Base W x D
Tri-Arc Model #	Tri-Arc Model #						
WITH HANDRAILS							
RWEC106246-XR	RWEC106242-XR	6	24"	60"	100"	24" x 27"	35" x 76"
RWEC107246-XR	RWEC107242-XR	7	24"	70"	110"	24" x 27"	35" x 84"
RWEC108246-XR	RWEC108242-XR	8	24"	80"	120"	24" x 27"	35" x 92"
RWEC109246-XR	RWEC109242-XR	9	24"	90"	130"	24" x 27"	35" x 101"
RWEC110246-XR	RWEC110242-XR	10	24"	100"	140"	24" x 27"	35" x 109"
RWEC111246-XR	RWEC111242-XR	11	24"	110"	150"	24" x 27"	35" x 117"
RWEC112246-XR	RWEC112242-XR	12	24"	120"	160"	24" x 27"	35" x 126"
RWEC113246-XR	RWEC113242-XR	13	24"	130"	170"	24" x 27"	40" x 134"
RWEC114246-XR	RWEC114242-XR	14	24"	140"	180"	24" x 27"	40" x 142"
RWEC115246-XR	RWEC115242-XR	15	24"	150"	190"	24" x 27"	40" x 151"

## MOBILE DOUBLE-SIDED STEEL WORK PLATFORM

### Features:

- 800 lb. rated capacity
- Grip Strut tread
- Ships all-welded
- 1-1/16" Tubular steel construction
- Access from two sides of platform
- Step Lock on both entries
- Powder coat gray finish
- Complies with applicable OSHA & ANSI standards



24" WIDE STEPS/PLATFORM						
GRIP STRUT	# of Steps	Step Width	Platform Height	Overall Height	Overall Length	Overall Width
Tri-Arc Model #						
47" PLATFORM LENGTH						
WLDS132447	3	24"	30"	66"	85"	35"
WLDS142447	4	24"	40"	76"	102"	35"
WLDS152447	5	24"	50"	86"	118"	35"
WLDS162447	6	24"	60"	96"	135"	35"
WLDS172447	7	24"	70"	106"	152"	35"
57" PLATFORM LENGTH						
WLDS132457	3	24"	30"	66"	95"	35"
WLDS142457	4	24"	40"	76"	112"	35"
WLDS152457	5	24"	50"	86"	128"	35"
WLDS162457	6	24"	60"	96"	145"	35"
WLDS172457	7	24"	70"	106"	162"	35"
66" PLATFORM LENGTH						
WLDS132466	3	24"	30"	66"	104"	35"
WLDS142466	4	24"	40"	76"	121"	35"
WLDS152466	5	24"	50"	86"	137"	35"
WLDS162466	6	24"	60"	96"	154"	35"
WLDS172466	7	24"	70"	106"	171"	35"
76" PLATFORM LENGTH						
WLDS132476	3	24"	30"	66"	114"	35"
WLDS142476	4	24"	40"	76"	131"	35"
WLDS152476	5	24"	50"	86"	147"	35"
WLDS162476	6	24"	60"	96"	164"	35"
WLDS172476	7	24"	70"	106"	181"	35"

36" WIDE STEPS/PLATFORM						
GRIP STRUT	# of Steps	Step Width	Platform Height	Overall Height	Overall Length	Overall Width
Tri-Arc Model #						
47" PLATFORM LENGTH						
WLDS133647	3	36"	30"	66"	85"	40"
WLDS143647	4	36"	40"	76"	102"	40"
WLDS153647	5	36"	50"	86"	118"	40"
WLDS163647	6	36"	60"	96"	135"	40"
WLDS173647	7	36"	70"	106"	152"	40"
57" PLATFORM LENGTH						
WLDS133657	3	36"	30"	66"	95"	40"
WLDS143657	4	36"	40"	76"	112"	40"
WLDS153657	5	36"	50"	86"	128"	40"
WLDS163657	6	36"	60"	96"	145"	40"
WLDS173657	7	36"	70"	106"	162"	40"
66" PLATFORM LENGTH						
WLDS133666	3	36"	30"	66"	104"	40"
WLDS143666	4	36"	40"	76"	121"	40"
WLDS153666	5	36"	50"	86"	137"	40"
WLDS163666	6	36"	60"	96"	154"	40"
WLDS173666	7	36"	70"	106"	171"	40"
76" PLATFORM LENGTH						
WLDS133676	3	36"	30"	66"	114"	40"
WLDS143676	4	36"	40"	76"	131"	40"
WLDS153676	5	36"	50"	86"	147"	40"
WLDS163676	6	36"	60"	96"	164"	40"
WLDS173676	7	36"	70"	106"	181"	40"



## MOBILE STEEL WORK PLATFORM

### Features:

- 800 lb. rated capacity
- Grip Strut tread
- Ships all-welded
- 50° Safety angle incline
- Step Lock standard on Handrail models
- 1-1/16" Tubular steel construction
- Two 4" casters for easy transport - Non-Handrail models
- Two 2.5" diameter pads for stability
- Powder coat gray finish
- Complies with applicable OSHA & ANSI standards



WITH HANDRAILS						
GRIP STRUT						
Tri-Arc Model #	# of Steps	Step Width	Platform Height	Overall Height	Overall Length	Overall Width
<b>24"W x 24"L PLATFORM</b>						
WLWP122424SL	2	24"	20"	56"	35"	35"
WLWP132424SL	3	24"	30"	66"	43"	35"
WLWP142424SL	4	24"	40"	76"	51"	35"
WLWP152424SL	5	24"	50"	86"	60"	35"
<b>24"W x 35"L PLATFORM</b>						
WLWP122436SL	2	24"	20"	56"	46"	35"
WLWP132436SL	3	24"	30"	66"	54"	35"
WLWP142436SL	4	24"	40"	76"	62"	35"
WLWP152436SL	5	24"	50"	86"	71"	35"
<b>24"W x 47"L PLATFORM</b>						
WLWP122448SL	2	24"	20"	56"	58"	35"
WLWP132448SL	3	24"	30"	66"	66"	35"
WLWP142448SL	4	24"	40"	76"	74"	35"
WLWP152448SL	5	24"	50"	86"	83"	35"
<b>36"W x 35"L PLATFORM</b>						
WLWP123636SL	2	36"	20"	56"	46"	40"
WLWP133636SL	3	36"	30"	66"	54"	40"
WLWP143636SL	4	36"	40"	76"	62"	40"
WLWP153636SL	5	36"	50"	86"	71"	40"
<b>36"W x 47"L PLATFORM</b>						
WLWP123648SL	2	36"	20"	56"	58"	40"
WLWP133648SL	3	36"	30"	66"	66"	40"
WLWP143648SL	4	36"	40"	76"	74"	40"
WLWP153648SL	5	36"	50"	86"	83"	40"

WITHOUT HANDRAILS						
GRIP STRUT						
Tri-Arc Model #	# of Steps	Step Width	Platform Height	Overall Height	Overall Length	Overall Width
<b>24"W x 24"L PLATFORM</b>						
WLWP022424	2	24"	20"	20"	35"	28"
WLWP032424	3	24"	30"	30"	42"	28"
WLWP042424	4	24"	40"	40"	51"	28"
<b>24"W x 35"L PLATFORM</b>						
WLWP022436	2	24"	20"	20"	46"	28"
WLWP032436	3	24"	30"	30"	53"	28"
WLWP042436	4	24"	40"	40"	62"	28"
<b>24"W x 47"L PLATFORM</b>						
WLWP022448	2	24"	20"	20"	58"	28"
WLWP032448	3	24"	30"	30"	65"	28"
WLWP042448	4	24"	40"	40"	74"	28"
<b>36"W x 35"L PLATFORM</b>						
WLWP023636	2	36"	20"	20"	46"	40"
WLWP033636	3	36"	30"	30"	53"	40"
WLWP043636	4	36"	40"	40"	62"	40"
<b>36"W x 47"L PLATFORM</b>						
WLWP023648	2	36"	20"	20"	58"	40"
WLWP033648	3	36"	30"	30"	65"	40"
WLWP043648	4	36"	40"	40"	74"	40"

## MOBILE STEEL WORK PLATFORM

### Features:

- 800 lb. rated capacity
- Grip Strut tread
- Ships all-welded
- 50° Safety angle incline
- Step Lock standard on Handrail models
- 1-1/16" Tubular steel construction
- Two 4" casters for easy transport - Non-Handrail models
- Two 2.5" diameter pads for stability
- Safety yellow finish
- Complies with applicable OSHA & ANSI standards



WITH HANDRAILS						
GRIP STRUT						
Tri-Arc Model #	# of Steps	Step Width	Platform Height	Overall Height	Overall Length	Overall Width
<b>24"W x 24"L PLATFORM</b>						
WLWP122424SL-Y	2	24"	20"	56"	35"	35"
WLWP132424SL-Y	3	24"	30"	66"	43"	35"
WLWP142424SL-Y	4	24"	40"	76"	51"	35"
WLWP152424SL-Y	5	24"	50"	86"	60"	35"
<b>24"W x 35"L PLATFORM</b>						
WLWP122436SL-Y	2	24"	20"	56"	46"	35"
WLWP132436SL-Y	3	24"	30"	66"	54"	35"
WLWP142436SL-Y	4	24"	40"	76"	62"	35"
WLWP152436SL-Y	5	24"	50"	86"	71"	35"
<b>24"W x 47"L PLATFORM</b>						
WLWP122448SL-Y	2	24"	20"	56"	58"	35"
WLWP132448SL-Y	3	24"	30"	66"	66"	35"
WLWP142448SL-Y	4	24"	40"	76"	74"	35"
WLWP152448SL-Y	5	24"	50"	86"	83"	35"
<b>36"W x 35"L PLATFORM</b>						
WLWP123636SL-Y	2	36"	20"	56"	46"	40"
WLWP133636SL-Y	3	36"	30"	66"	54"	40"
WLWP143636SL-Y	4	36"	40"	76"	62"	40"
WLWP153636SL-Y	5	36"	50"	86"	71"	40"
<b>36"W x 47"L PLATFORM</b>						
WLWP123648SL-Y	2	36"	20"	56"	58"	40"
WLWP133648SL-Y	3	36"	30"	66"	66"	40"
WLWP143648SL-Y	4	36"	40"	76"	74"	40"
WLWP153648SL-Y	5	36"	50"	86"	83"	40"

WITHOUT HANDRAILS						
GRIP STRUT						
Tri-Arc Model #	# of Steps	Step Width	Platform Height	Overall Height	Overall Length	Overall Width
<b>24"W x 24"L PLATFORM</b>						
WLWP022424-Y	2	24"	20"	20"	35"	28"
WLWP032424-Y	3	24"	30"	30"	42"	28"
WLWP042424-Y	4	24"	40"	40"	51"	28"
<b>24"W x 35"L PLATFORM</b>						
WLWP022436-Y	2	24"	20"	20"	46"	28"
WLWP032436-Y	3	24"	30"	30"	53"	28"
WLWP042436-Y	4	24"	40"	40"	62"	28"
<b>24"W x 47"L PLATFORM</b>						
WLWP022448-Y	2	24"	20"	20"	58"	28"
WLWP032448-Y	3	24"	30"	30"	65"	28"
WLWP042448-Y	4	24"	40"	40"	74"	28"
<b>36"W x 35"L PLATFORM</b>						
WLWP023636-Y	2	36"	20"	20"	46"	40"
WLWP033636-Y	3	36"	30"	30"	53"	40"
WLWP043636-Y	4	36"	40"	40"	62"	40"
<b>36"W x 47"L PLATFORM</b>						
WLWP023648-Y	2	36"	20"	20"	58"	40"
WLWP033648-Y	3	36"	30"	30"	65"	40"
WLWP043648-Y	4	36"	40"	40"	74"	40"

# REFRIGERATOR TRUCK ROLLING ACCESS PLATFORM

Provides fall protection during routine maintenance and inspection of refrigeration units on small- to medium-sized trucks.

**Features:**

- Adjustable platform height (12" adjustability in 4" increments)
- Large platform to perform work from (24"W x 120"L)
- Serrated tread surface offers excellent slip resistance and drainage properties
- Ladders on both sides for dual access
- Snap chains at entry/exit points and on refrigeration unit access opening
- Designated lifting point for using rope and bucket to bring tools or parts from ground to platform
- Reinforced lifting points on each ladder at 4th step to accommodate adjustability using standard engine puller
- Powder coated safety yellow (adjustable legs orange powder coat)
- Ships in 3 pieces (1 platform & 2 ladders), assembly required



**REFRIGERATOR TRUCK ROLLING ACCESS PLATFORM**

Tri-Arc Model #	RA10FT-R09
Platform Height	103" to 115"
Load Capacity	450 lb.
Base Length	130"
Base Width	50"
Platform Length	120"
Platform Width	24"
Overall Height	145" to 157"
Handrail Height	42"
# of Guard Rails	3
# of Steps	7
Step Width	24"
Step Depth	7"

# MOBILE FOLDAWAY STEP STAND

Combines the features and benefits of a rolling ladder and step stand.

**Features:**

- Easily folds for storage
- 10" deep top platform
- 7" deep steps
- 300 lb. rated capacity
- Perforated tread
- Ships knocked down
- 1-1/16" Tubular steel construction
- Powder coat gray finish
- Complies with applicable OSHA & ANSI standards



**MOBILE FOLDAWAY STEP STAND**

PERFORATED						
Tri-Arc Model #	# of Steps	Step Width	Platform Height	Overall Height	Platform W x L	Base W x D
KDMF102166	2	16"	20"	44"	16" x 10"	21" x 20"
KDMF103166	3	16"	30"	54"	16" x 10"	21" x 27"
KDMF104166	4	16"	40"	64"	16" x 10"	21" x 34"

## MOBILE STEP STOOL

### Features:

- 450 rated capacity - Steel
- 350 rated capacity - Aluminum
- Anti-Slip, Perforated or Grip Strut - Steel
- Solid Ribbed or Grip Strut - Aluminum
- Powder coat gray finish - Steel
- Standard mill finish - Aluminum
- Ships UPS
- Complies with applicable OSHA & ANSI standards



MOBILE STEP STOOL						
STEEL						
ANTI-SLIP	PERFORATED	GRIP STRUT				
Tri-Arc Model #	Tri-Arc Model #	Tri-Arc Model #	# of Steps	Step Height	Step Width	Step Length
WLSR001163-WM	WLSR001166	WLSR001162	1	12"	16"	10"
WLSR001243	WLSR001246	WLSR001242	1	12"	24"	10"
ALUMINUM						
	RIBBED	GRIP STRUT				
	Tri-Arc Model #	Tri-Arc Model #	# of Steps	Step Height	Step Width	Step Length
	WLAR001164	WLAR001165	1	12"	16"	14"
	WLAR001244	WLAR001245	1	12"	24"	14"

## INDUSTRIAL ACCESS STAIRWAY LADDER

### Features:

- 45° safety angle incline
- 450 lb. rated capacity
- Perforated or Grip Strut tread
- Ships all-welded
- 1.5" round tubular handrails
- 1"x 2" rectangular frame
- Powder coat gray finish
- Complies with applicable OSHA & ANSI standards



INDUSTRIAL ACCESS STAIRWAY LADDER							
PERFORATED	GRIP STRUT						
Tri-Arc Model #	Tri-Arc Model #	# of Steps	Step Width	Platform Height	Overall Height	Platform W x L	Base W x D
WISS106246	WISS106242	6	24"	57.0"	95.0"	24" x 10"	26.5" x 58.0"
WISS107246	WISS107242	7	24"	66.5"	104.5"	24" x 10"	26.5" x 67.5"
WISS108246	WISS108242	8	24"	76.0"	114.0"	24" x 10"	26.5" x 77.0"
WISS109246	WISS109242	9	24"	85.5"	123.5"	24" x 10"	26.5" x 86.5"
WISS110246	WISS110242	10	24"	95.0"	133.0"	24" x 10"	26.5" x 96.0"
WISS111246	WISS111242	11	24"	104.5"	142.5"	24" x 10"	26.5" x 105.5"
WISS112246	WISS112242	12	24"	114.0"	152.0"	24" x 10"	26.5" x 115.0"

## FIXED STEEL LADDER

### Features:

- Side rails 2-1/2" x 3/8" flat bar
- Solid round 3/4" rungs
- 12" Spacing between rungs
- 18" Ladder width
- 42" Guardrails on Walk-Thru models
- Powder coat gray finish
- Complies with applicable OSHA & ANSI standards



Cage / Walk-Thru

Without Cage / Standard

FIXED STEEL LADDER							
WITH CAGE				WITHOUT CAGE			
STANDARD	WALK-THRU	# of Rungs	Length top to bottom rung	STANDARD	WALK-THRU	# of Rungs	Length top to bottom rung
Tri-Arc Model #	Tri-Arc Model #			Tri-Arc Model #	Tri-Arc Model #		
WLFC1111	WLFC1211	11	10'	WLFS0104	WLFS0204	4	3'
WLFC1112	WLFC1212	12	11'	WLFS0105	WLFS0205	5	4'
WLFC1113	WLFC1213	13	12'	WLFS0106	WLFS0206	6	5'
WLFC1114	WLFC1214	14	13'	WLFS0107	WLFS0207	7	6'
WLFC1115	WLFC1215	15	14'	WLFS0108	WLFS0208	8	7'
WLFC1116	WLFC1216	16	15'	WLFS0109	WLFS0209	9	8'
WLFC1117	WLFC1217	17	16'	WLFS0110	WLFS0210	10	9'
WLFC1118	WLFC1218	18	17'	WLFS0111	WLFS0211	11	10'
WLFC1119	WLFC1219	19	18'	WLFS0112	WLFS0212	12	11'
WLFC1120	WLFC1220	20	19'	WLFS0113	WLFS0213	13	12'
WLFC1121	WLFC1221	21	20'	WLFS0114	WLFS0214	14	13'
WLFC1122	WLFC1222	22	21'	WLFS0115	WLFS0215	15	14'
WLFC1123	WLFC1223	23	22'	WLFS0116	WLFS0216	16	15'
WLFC1124	WLFC1224	24	23'	WLFS0117	WLFS0217	17	16'
WLFC1125	WLFC1225	25	24'	WLFS0118	WLFS0218	18	17'
WLFC1126	WLFC1226	26	25'	WLFS0119	WLFS0219	19	18'
WLFC1127	WLFC1227	27	26'	WLFS0120	WLFS0220	20	19'
WLFC1128	WLFC1228	28	27'				
WLFC1129	WLFC1229	29	28'				
WLFC1130	WLFC1230	30	29'				

### FIXED LADDER ACCESS RESTRICTION OPTIONS

Guard Door closes off entry onto a fixed ladder. Cage Door closes off entry at bottom of cage.

Guard Door	OPFS03
Cage Door	OPFS04

## FIXED STEEL LADDER

### Features:

- Side rails 2-1/2" x 3/8" flat bar
- Solid round 3/4" rungs
- 12" Spacing between rungs
- 18" Ladder width
- 42" Guardrails on Walk-Thru models
- Safety yellow finish
- Complies with applicable OSHA & ANSI standards

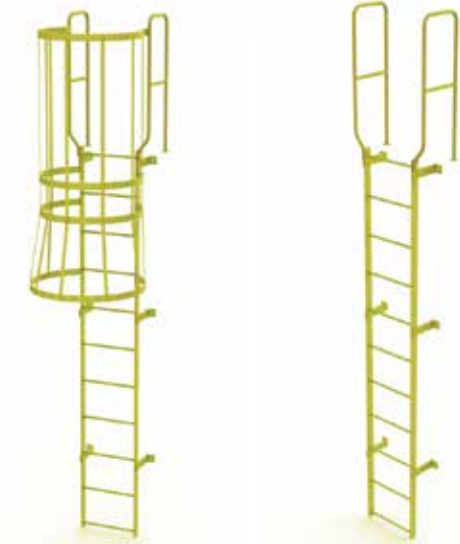

Cage / Walk-Thru

Without Cage / Standard

FIXED STEEL LADDER							
WITH CAGE				WITHOUT CAGE			
STANDARD	WALK-THRU	# of Rungs	Length top to bottom rung	STANDARD	WALK-THRU	# of Rungs	Length top to bottom rung
Tri-Arc Model #	Tri-Arc Model #			Tri-Arc Model #	Tri-Arc Model #		
WLFC1111-Y	WLFC1211-Y	11	10'	WLFS0104-Y	WLFS0204-Y	4	3'
WLFC1112-Y	WLFC1212-Y	12	11'	WLFS0105-Y	WLFS0205-Y	5	4'
WLFC1113-Y	WLFC1213-Y	13	12'	WLFS0106-Y	WLFS0206-Y	6	5'
WLFC1114-Y	WLFC1214-Y	14	13'	WLFS0107-Y	WLFS0207-Y	7	6'
WLFC1115-Y	WLFC1215-Y	15	14'	WLFS0108-Y	WLFS0208-Y	8	7'
WLFC1116-Y	WLFC1216-Y	16	15'	WLFS0109-Y	WLFS0209-Y	9	8'
WLFC1117-Y	WLFC1217-Y	17	16'	WLFS0110-Y	WLFS0210-Y	10	9'
WLFC1118-Y	WLFC1218-Y	18	17'	WLFS0111-Y	WLFS0211-Y	11	10'
WLFC1119-Y	WLFC1219-Y	19	18'	WLFS0112-Y	WLFS0212-Y	12	11'
WLFC1120-Y	WLFC1220-Y	20	19'	WLFS0113-Y	WLFS0213-Y	13	12'
WLFC1121-Y	WLFC1221-Y	21	20'	WLFS0114-Y	WLFS0214-Y	14	13'
WLFC1122-Y	WLFC1222-Y	22	21'	WLFS0115-Y	WLFS0215-Y	15	14'
WLFC1123-Y	WLFC1223-Y	23	22'	WLFS0116-Y	WLFS0216-Y	16	15'
WLFC1124-Y	WLFC1224-Y	24	23'	WLFS0117-Y	WLFS0217-Y	17	16'
WLFC1125-Y	WLFC1225-Y	25	24'	WLFS0118-Y	WLFS0218-Y	18	17'
WLFC1126-Y	WLFC1226-Y	26	25'	WLFS0119-Y	WLFS0219-Y	19	18'
WLFC1127-Y	WLFC1227-Y	27	26'	WLFS0120-Y	WLFS0220-Y	20	19'
WLFC1128-Y	WLFC1228-Y	28	27'				
WLFC1129-Y	WLFC1229-Y	29	28'				
WLFC1130-Y	WLFC1230-Y	30	29'				

### FIXED LADDER ACCESS RESTRICTION OPTIONS

Guard Door closes off entry onto a fixed ladder. Cage Door closes off entry at bottom of cage.

Guard Door	OPFS03-Y
Cage Door	OPFS04-Y